

West Harbor Drive

Pacific Coast Hwy.

Kellner Blvd

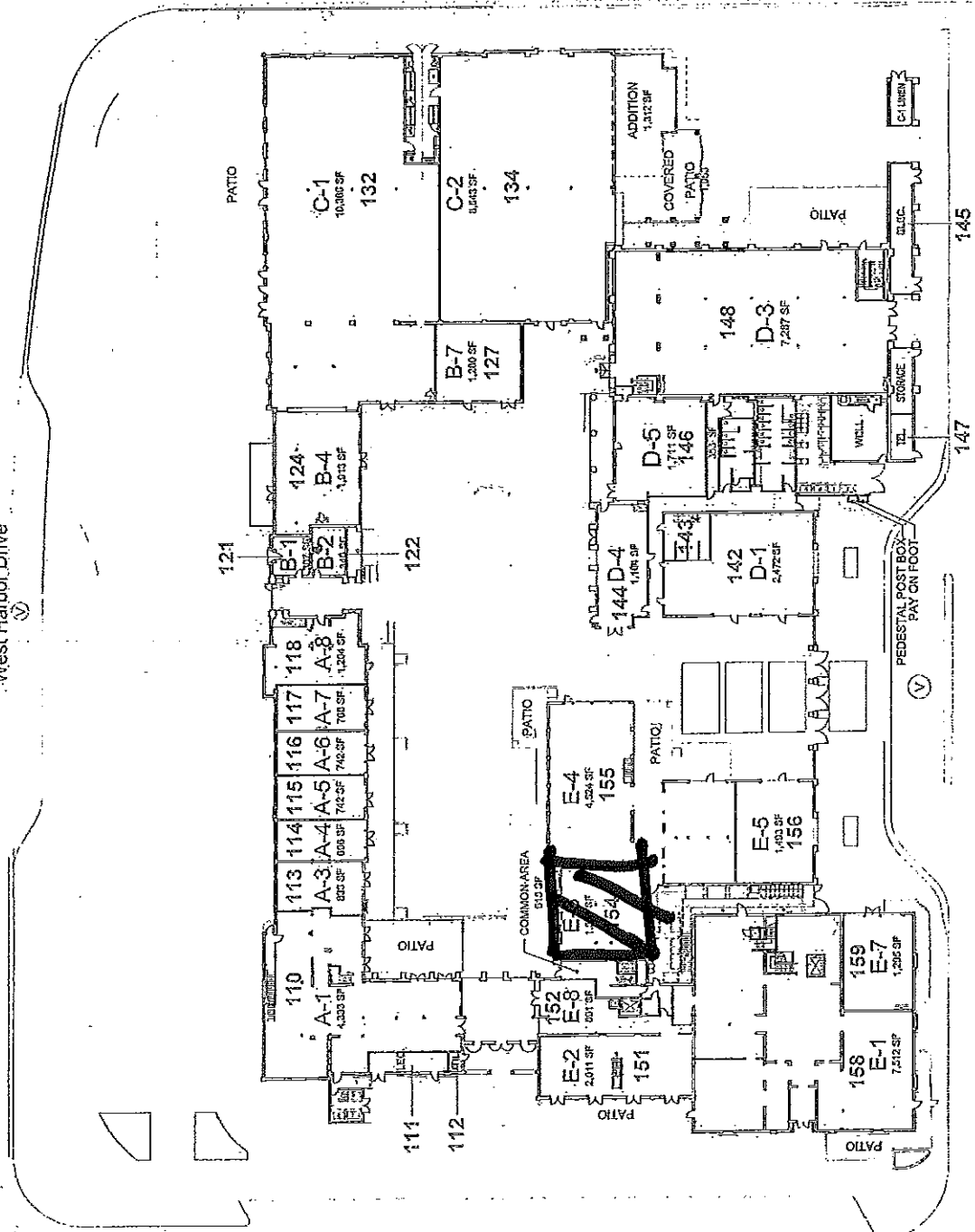

THIS EXHIBIT/DRAWING IS NOT A REPRESENTATION, WARRANTY, OR AGREEMENT AS TO THE LOCATION, OR RESULTS OF ANY PROPOSED IMPROVEMENTS. ALL INFORMATION AND PROPOSED IMPROVEMENTS ARE CURRENTLY SUBJECT TO SUCH CHANGES AS THE ARCHITECT, LANDLORD, OR ANY GOVERNMENT AGENCY MAY DIRECT.

8870 Nevada Gardens, Suite #205
 San Diego, CA 92123
 (619) 584-8000 P
 (619) 584-8007 F



LEASING PLAN - FIRST FLOOR

June 11, 2018